



5 Greencroft

Bridewell, Ashford, TN23 5LG

Price £270,000

A very well presented semi detached house in a popular residential location, within easy reach of popular local schools and amenities.

The property comprises an entrance hall, sitting room, kitchen, two bedrooms and bathroom/WC. The rear garden is pleasantly enclosed with further benefits including gas central heating, double glazing and driveway for off road parking.

Viewing

Please contact our Ashford Office on 01233 646411 if you wish to arrange a viewing appointment for this property or require further information.

- SEMI DETACHED HOUSE
- TWO BEDROOMS
- DRIVEWAY PROVIDING OFF ROAD PARKING
- FITTED KITCHEN
- GAS CENTRAL HEATING
- DOUBLE GLAZING
- ENCLOSED REAR GARDEN
- VERY WELL PRESENTED

Floor Plan

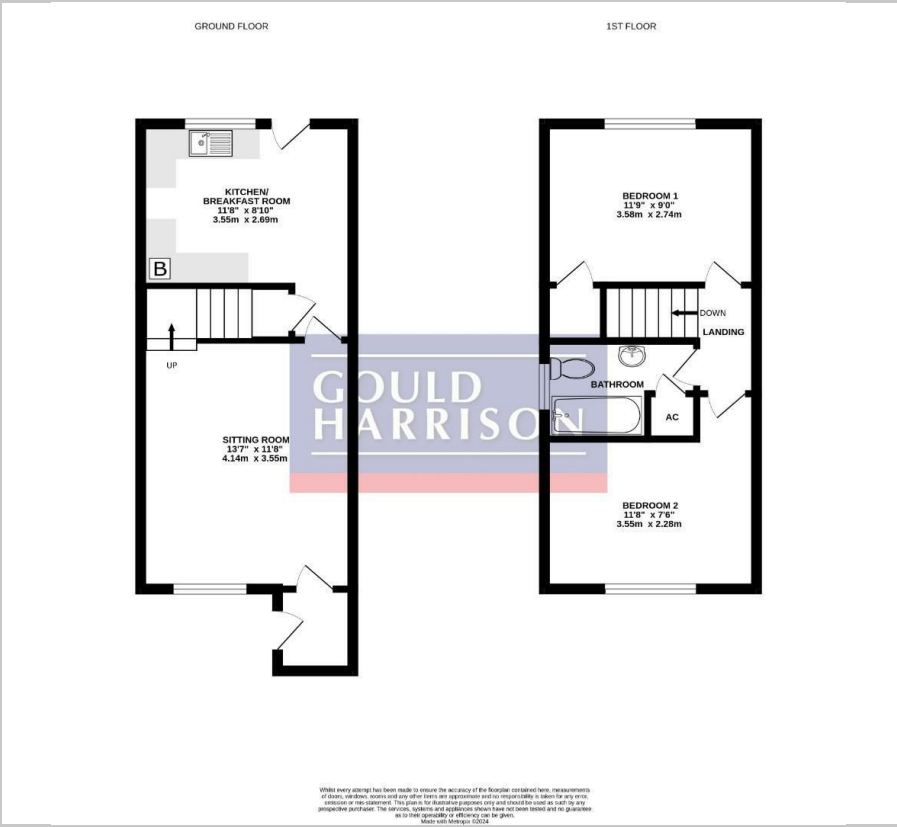

Area Map



Energy Efficiency Graph

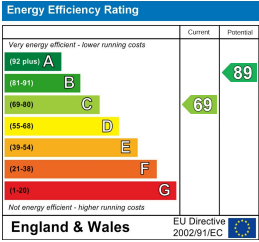

These particulars, whilst believed to be accurate are set out as a general outline only for guidance and do not constitute any part of an offer or contract. Intending purchasers should not rely on them as statements of representation of fact, but must satisfy themselves by inspection or otherwise as to their accuracy. No person in this firm's employment has the authority to make or give any representation or warranty in respect of the property.